

PRIME DESIGN™

A Safe Fleet Brand

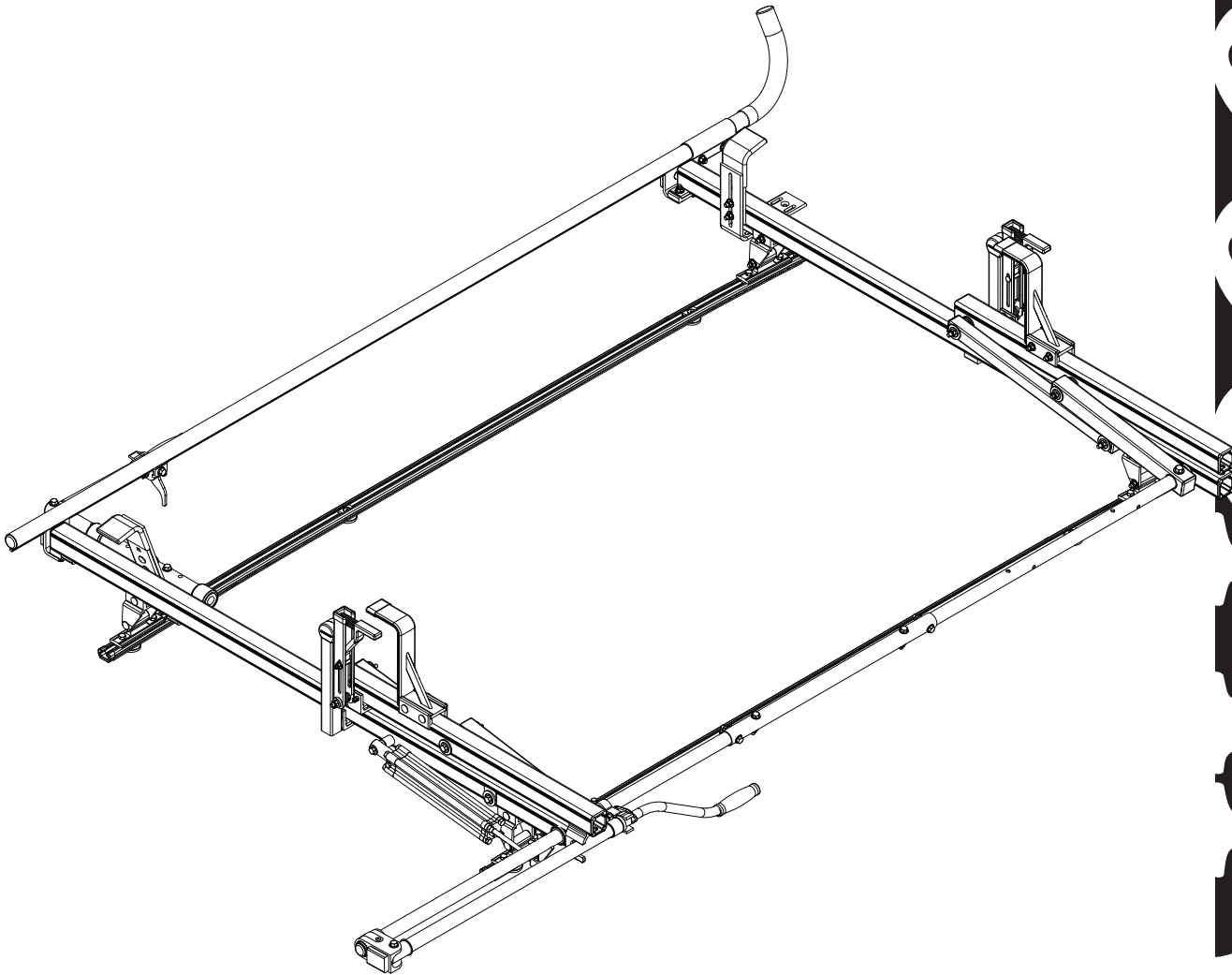

VCR 200

CONTENTS OVERVIEW

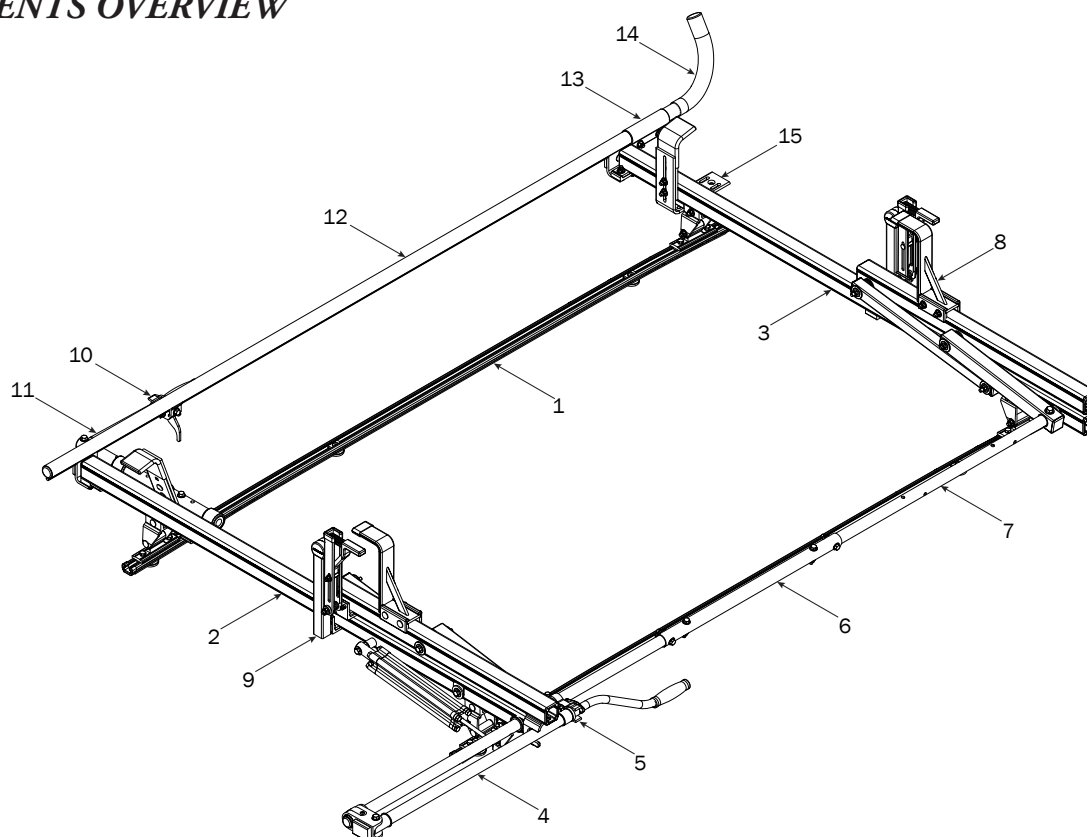

1—FBM-0045 (Qty 1)
Channels with Hardware



Channels (2X)

End Caps (4X)

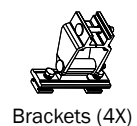

Brackets (4X)

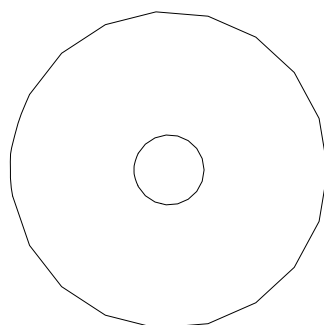

Nylon Washer (6X)

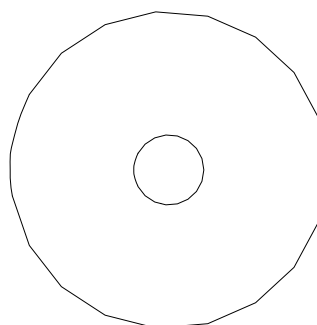

Foam Gasket (6X)

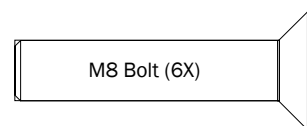

M8 Bolt (6X)

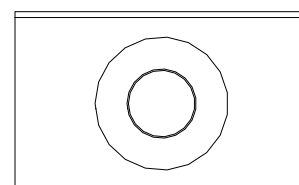

Flex Channel Connector (6X)

2—Rear Crossbar Assembly (Qty 1)

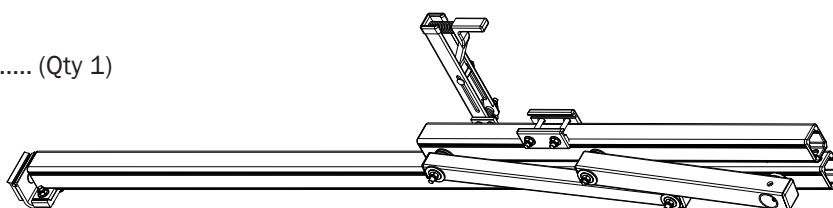

3—Front Crossbar Assembly (Qty 1)

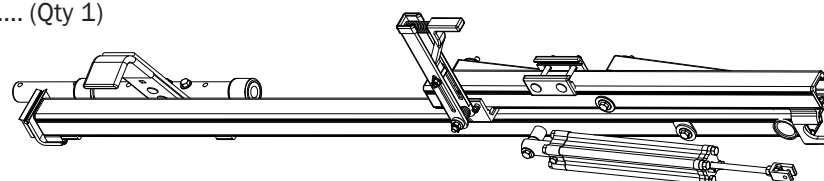

4—Rear Drive Shaft..... (Qty 1)
Right Hand, B4 Version, 46.00"

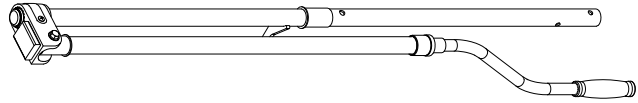

5—Handle Latch Assembly (Qty 1)
Right Hand



6—Connecting Bar..... (Qty 1)
24.00"

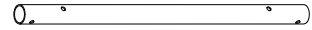

7—Front Drive Shaft (Qty 1)
B Version, 35.75"

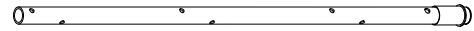

8—Z Post (Qty 2)
Adjustable, 7.25"

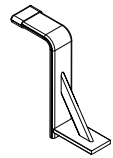

9—L Post (Qty 2)
Gen2, Roller Cap , 9.25"

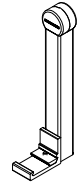

10—Handle Latch Assembly (Qty 1)
Left Hand, Clamp Down



11—Clamp Down Handle Assembly (Qty 1)
With hardware

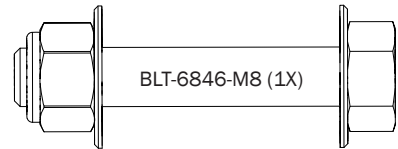
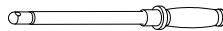

12—Clamp Down Tube (Qty 1)
80.00"

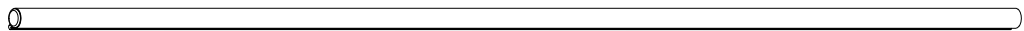

13—Quick Clamp Tube Splice..... (Qty 1)
5.00"



14—Removeable Horn (Qty 1)
With cap, 15.00"

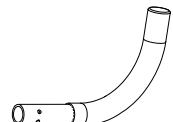

15—Front Hook Assembly..... (Qty 1)
Heavy Duty, Adjustable

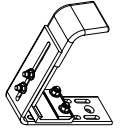

HKT-8162-Rotation Hardware Kit

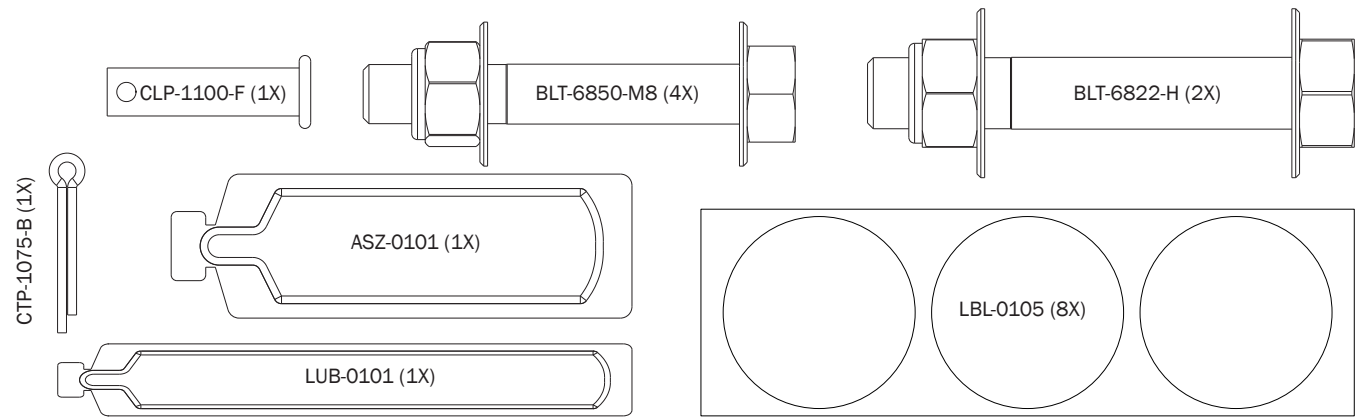

FBM-0045

CHANNELS TO ROOF

- 0.1** Position Channels as shown below in Fig.1

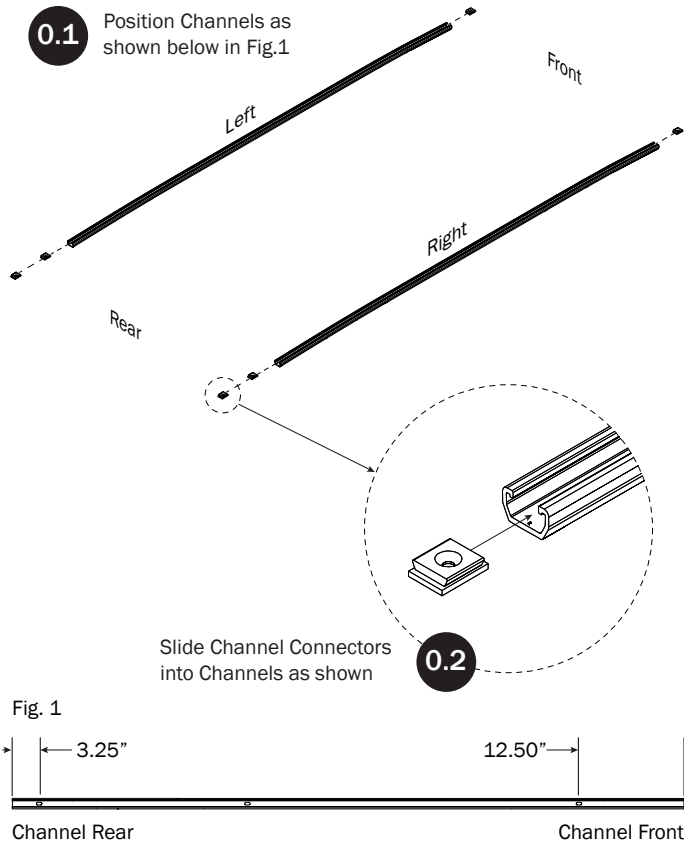

- 0.3** Install Channels into roof Channel groove as shown

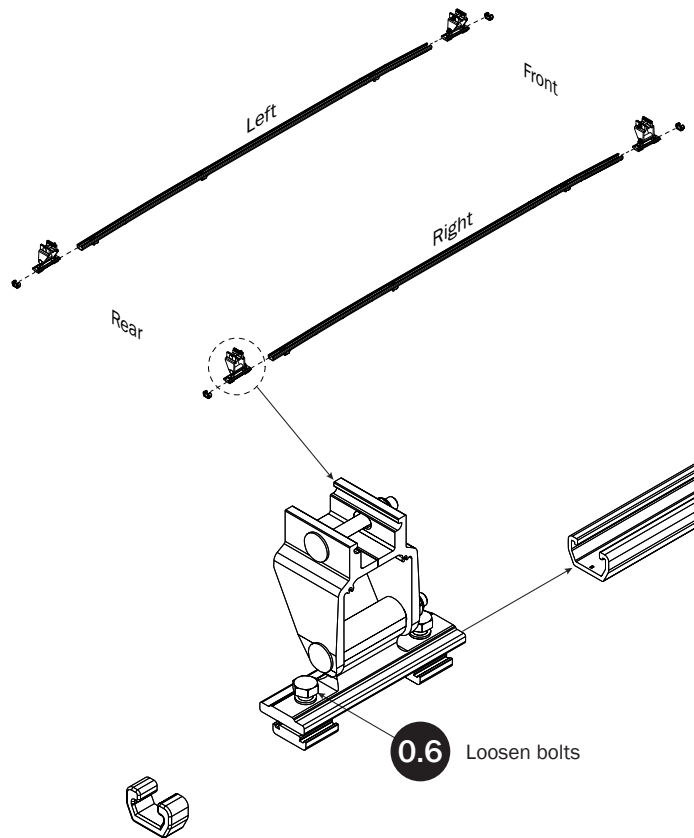
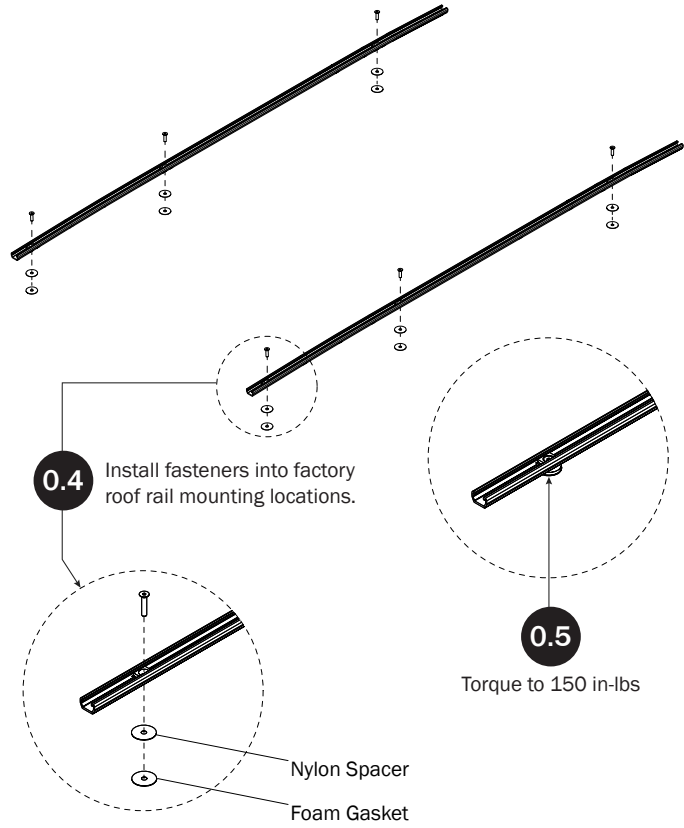

- 0.7** Set to distances then torque Rear Bracket nuts to 90 in-lbs

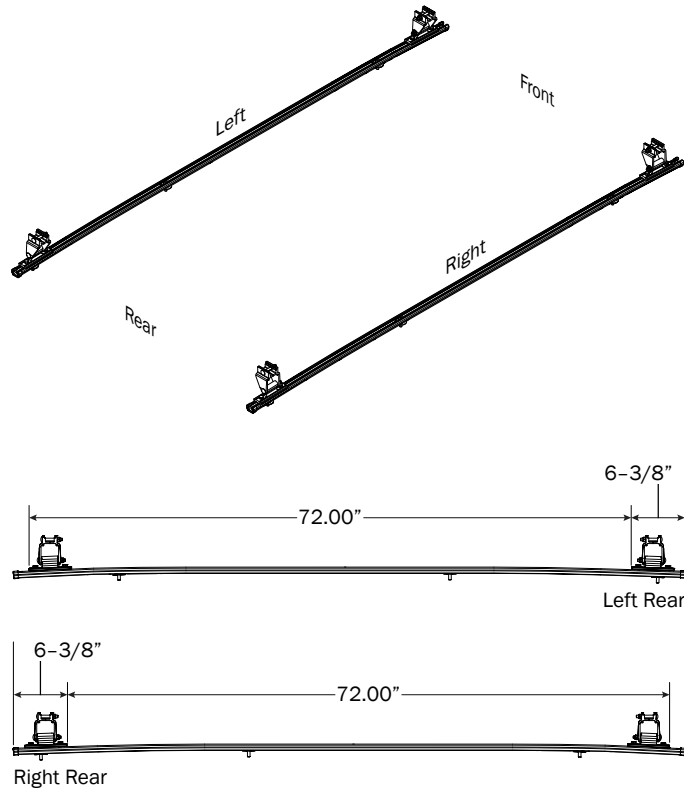

RIGHT ROTATION ASSEMBLY SEQUENCE

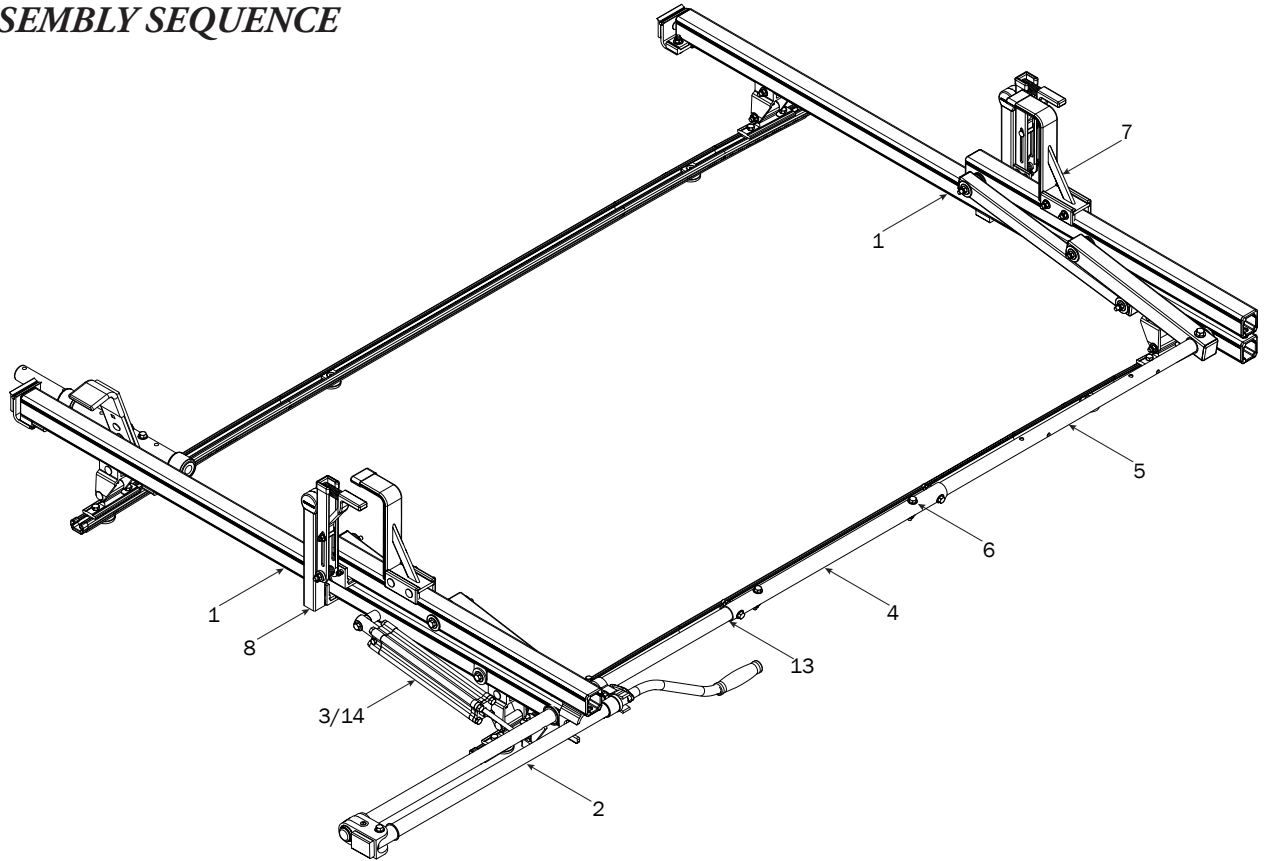

CROSSBARS

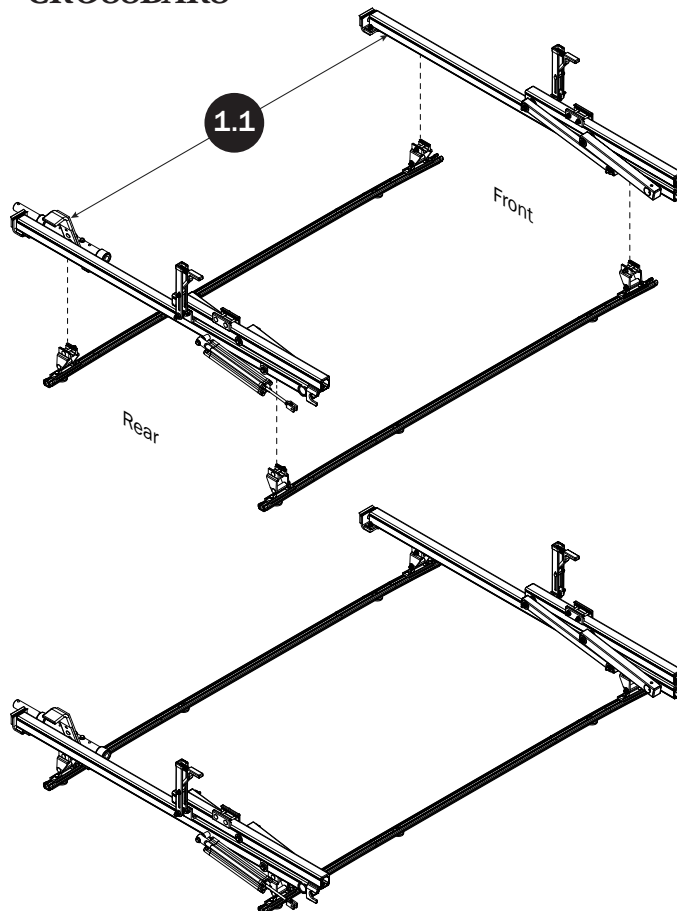

CROSSBAR ADJUSTMENT

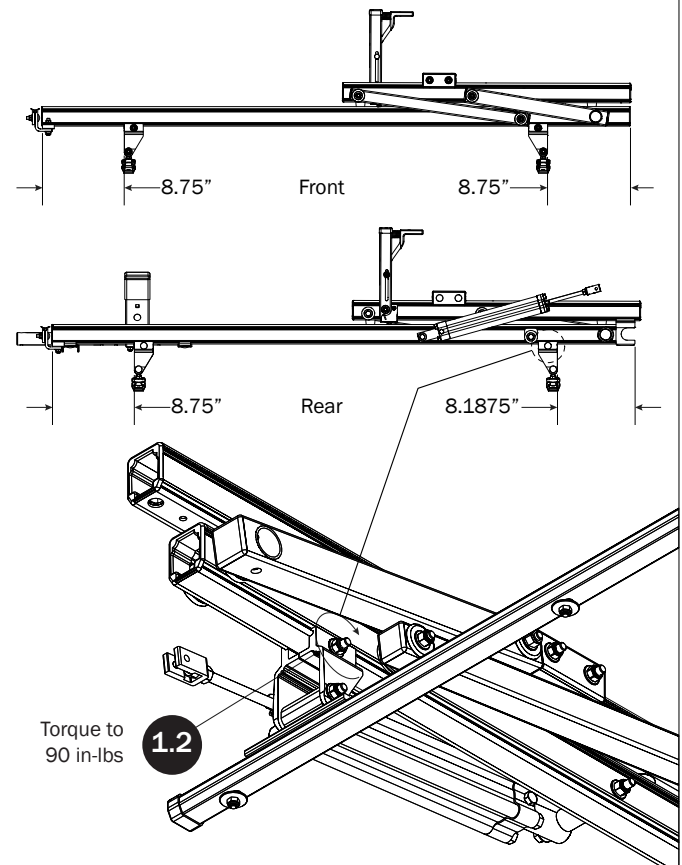

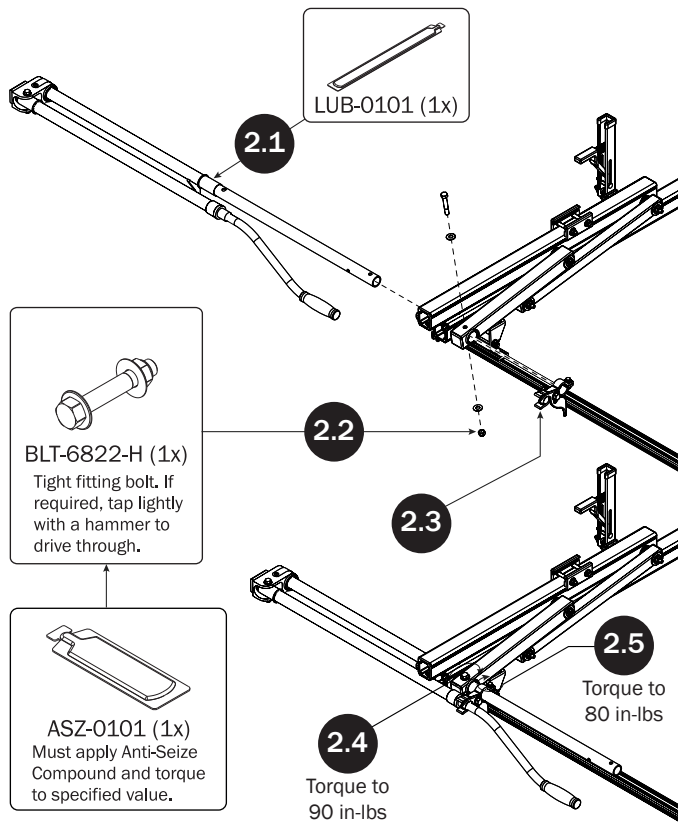
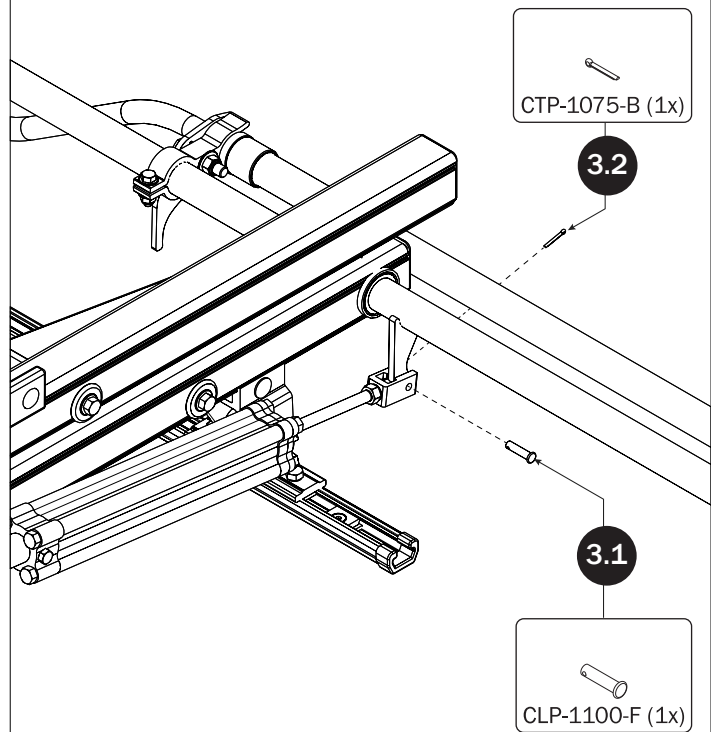
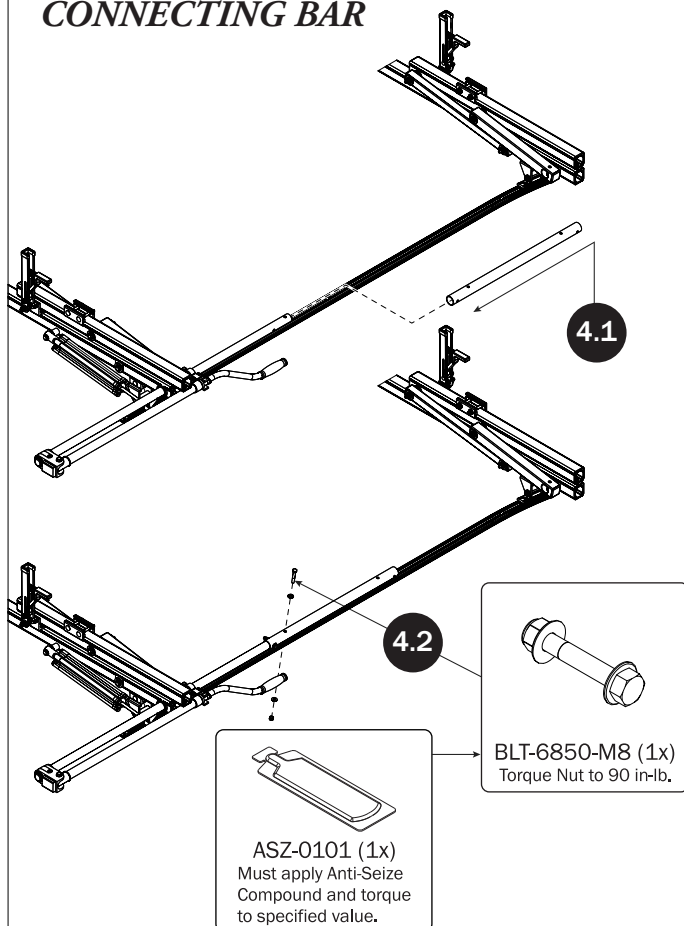
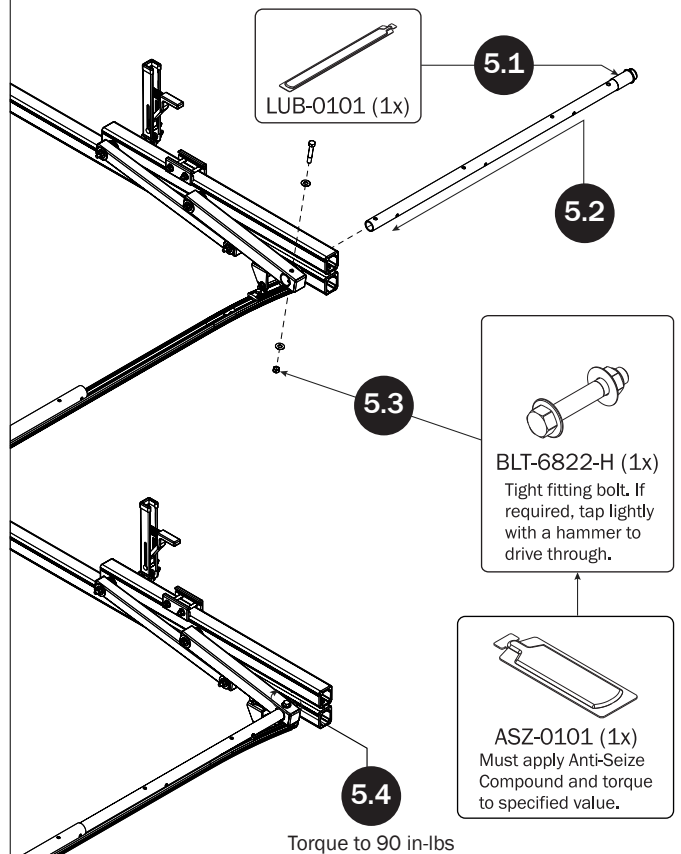
REAR DRIVE SHAFT**CYLINDER HARDWARE****CONNECTING BAR****FRONT DRIVE SHAFT**

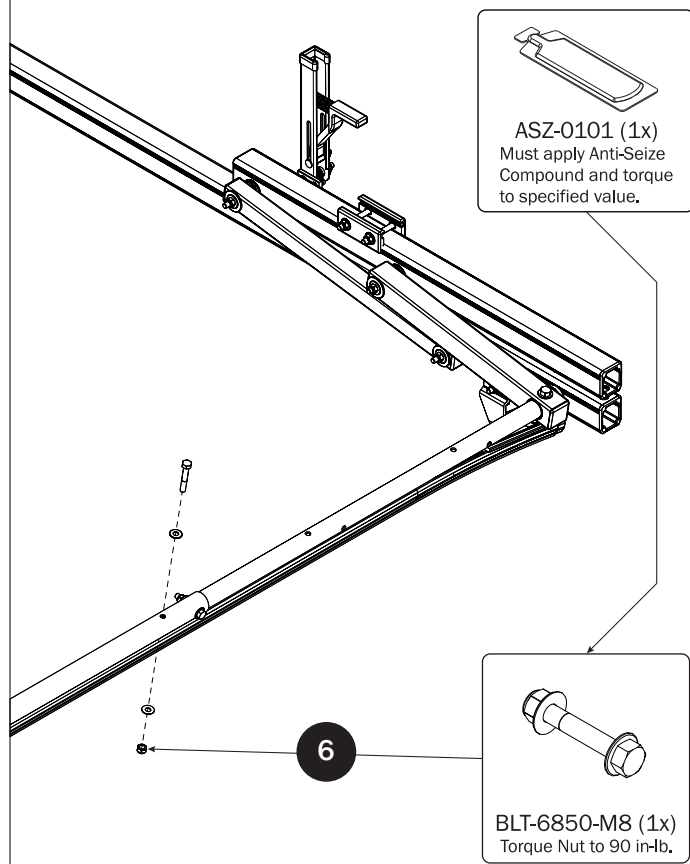
CONNECTING BAR FASTENERS**Z POSTS**

SEE QUICK START GUIDE FOR ADJUSTMENTS

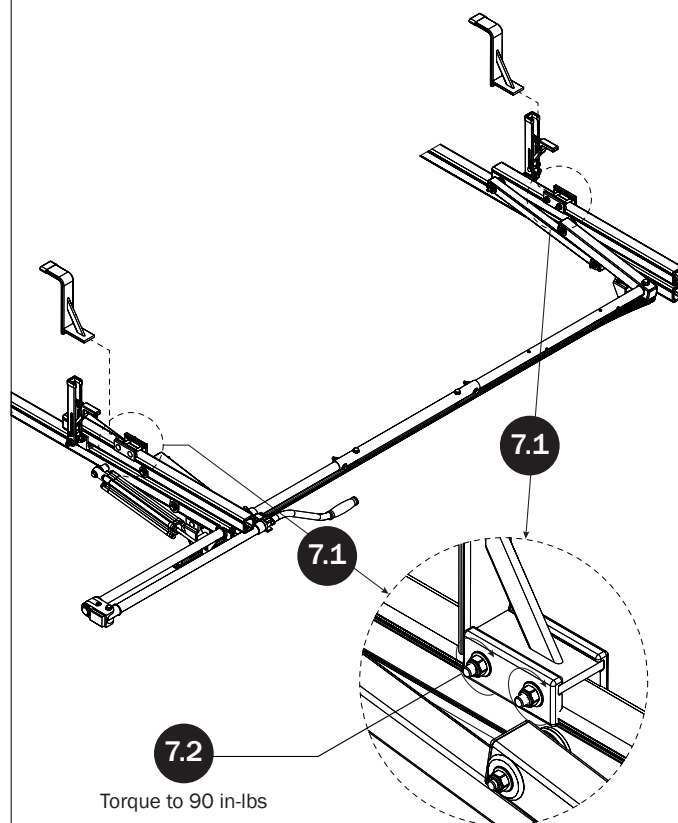
**L POSTS**

SEE QUICK START GUIDE FOR ADJUSTMENTS

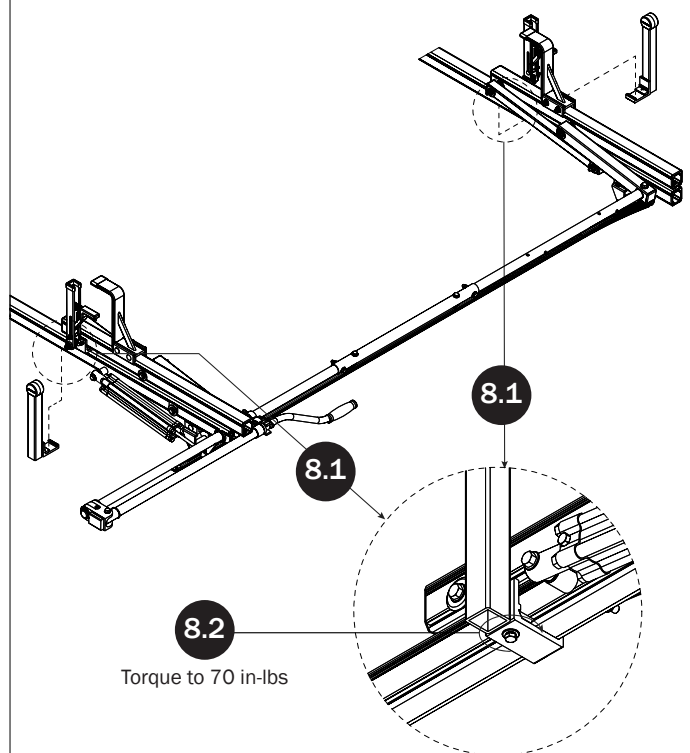

LEFT CLAMP DOWN ASSEMBLY SEQUENCE

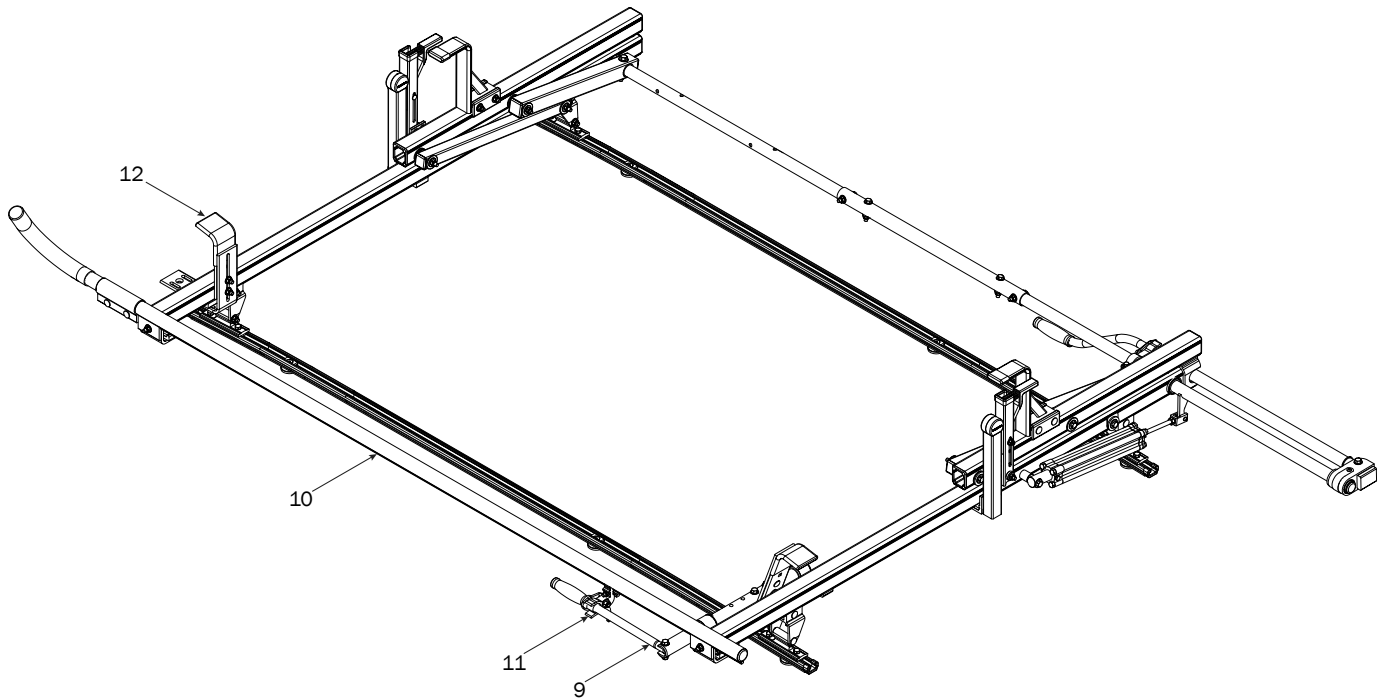

CLAMP DOWN HANDLE

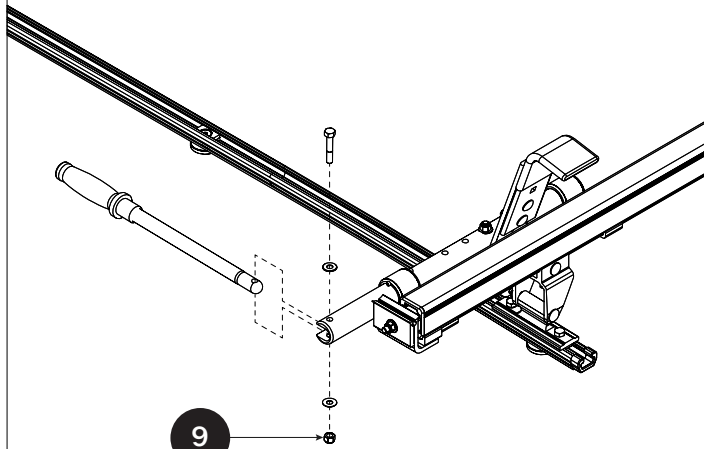

9

BLT-6846-M8 (1x)
Torque Nut to 90 in-lb.

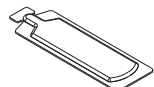

ASZ-0101 (1x)
Must apply Anti-Seize
Compound and torque
to specified value.

CLAMP DOWN TUBE

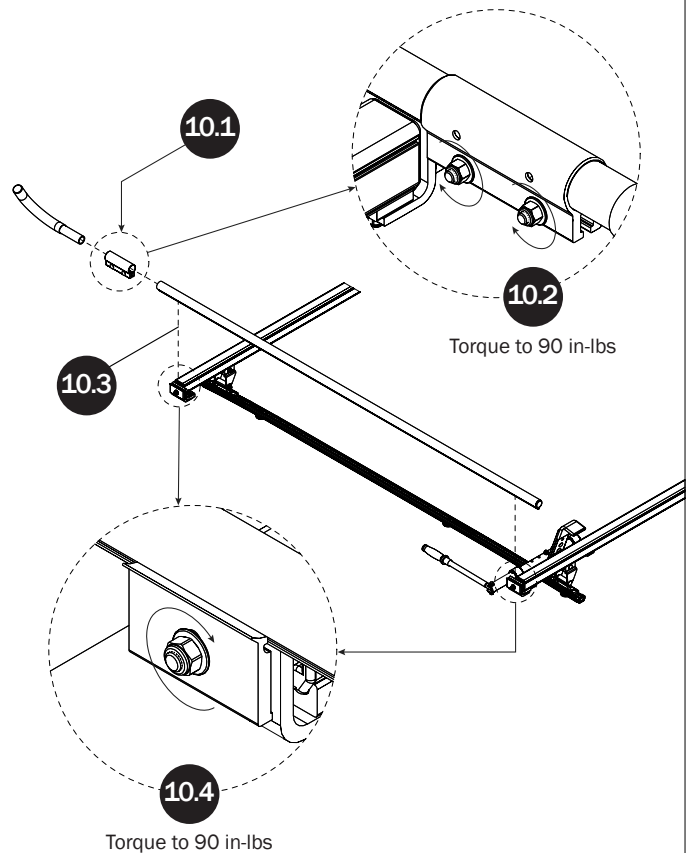

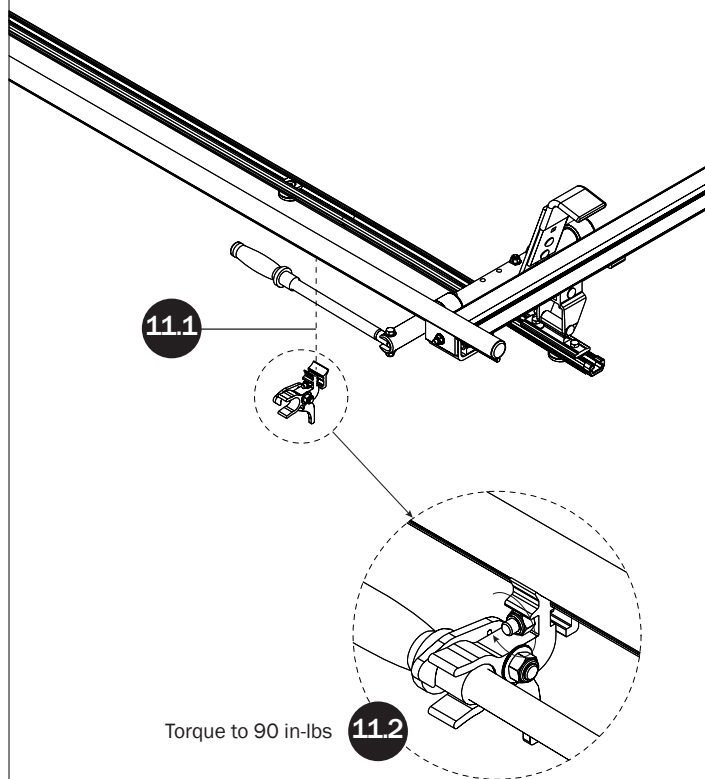
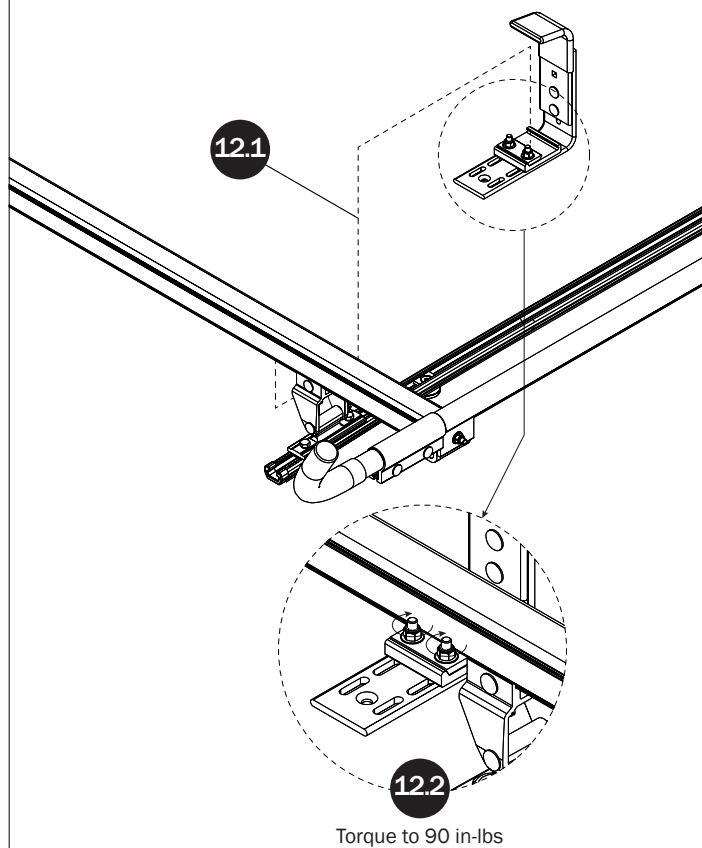
HANDLE LATCH**FRONT LADDER HOOK**
SEE QUICK START GUIDE FOR ADJUSTMENTS

DRIVE SHAFT SEALING

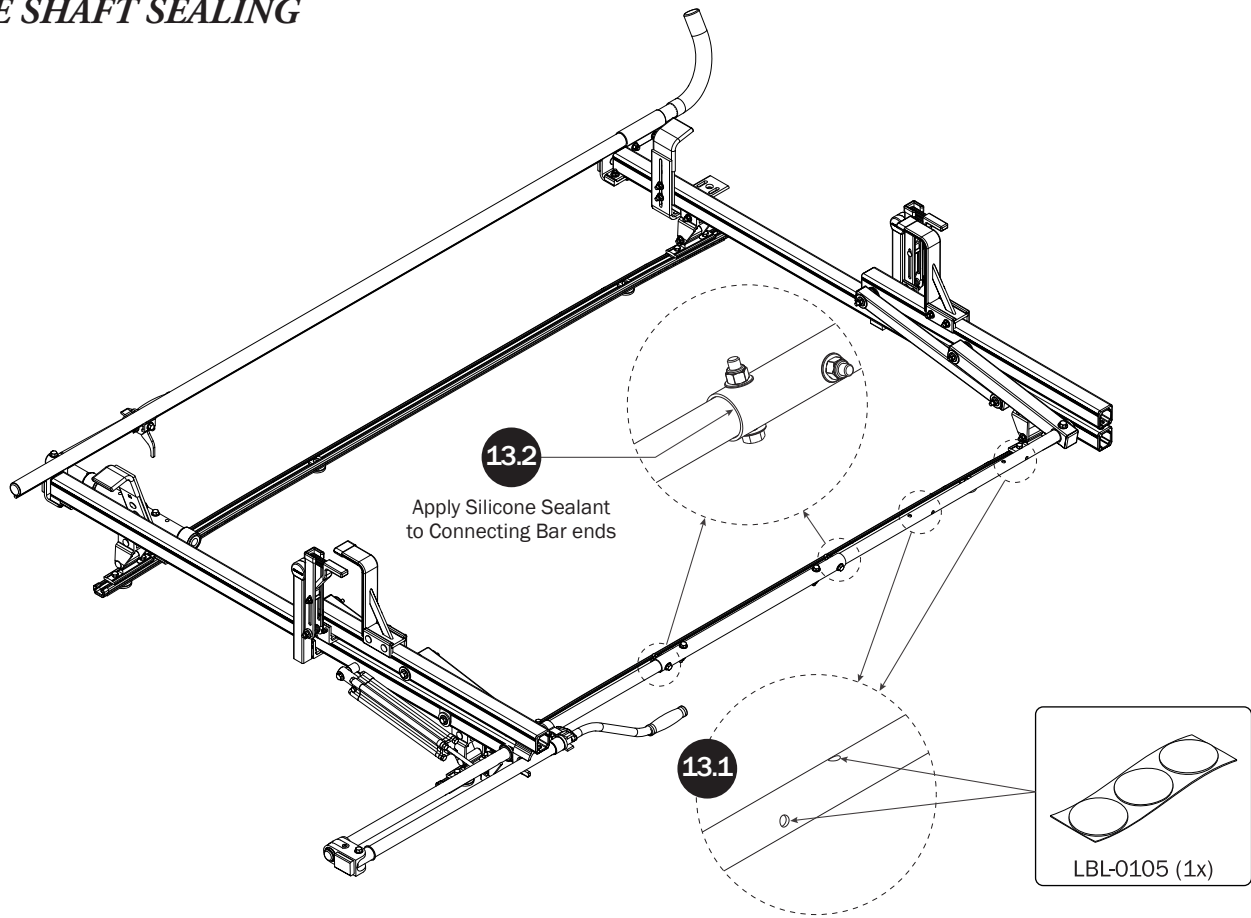

CYLINDER ADJUSTMENT

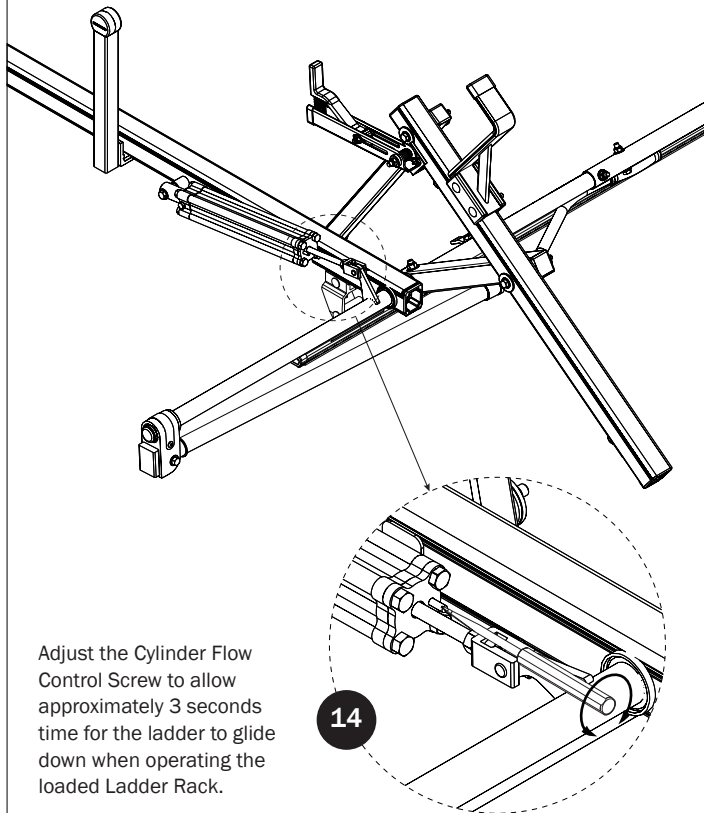

ADDITIONAL INFORMATION

For additional information regarding your VCR-NV200 Ladder Rack, please visit the Prime Design website at: www.primedesign.net.

Using a QR code reader in your smart phone or tablet, read the QR Code shown below and follow the same steps as you would from your laptop or computer.

If you're viewing this document as an interactive PDF, you may simply click on the QR Code below to access the Prime Design website.

